

Images may include options.

## Programmable Fast Action Knife

- Self-contained system does not require electronic motor
- Binding
- Taping
- Belt Loops
- Apron Strings
- Cap Sweat Bands
- Collarettes
- Most industrial sewing machines

### DESCRIPTION

An electronically controlled pneumatic scissor-type knife designed to cut apart and/or trim continuous sewn material such as binding, belt loops, waistbands, etc., up to 1 1/2" wide. This unit consists of a fast action toggle link knife, a keypad programmable control box with LCD readout, edge sensing and stitch count capability, with automatic binding saver to prevent material waste.

### OPERATION

The operator selects any programmed function by pressing numbers on the keypad (the stitch count and cut function are clearly visible on an LCD readout). Each sequence may be inspected or altered by following the program sequence; for example, program one, cut leading and trailing edge with automatic binding saver: material is inserted into a binder and depressing the sew treadle initiates sewing. A reflective eye senses the leading edge and the binding is cut after a preset number of stitches without stopping. Sewing continues until the trailing edge is sensed and after counting the preset number of stitches the binding is cut and sewing is automatically stopped to prevent material waste. Any number of cut and trim values may be entered and retained for different styles or sizes.

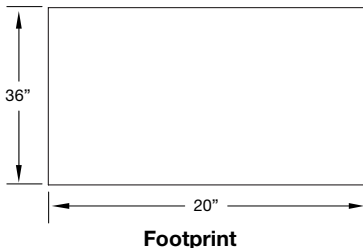
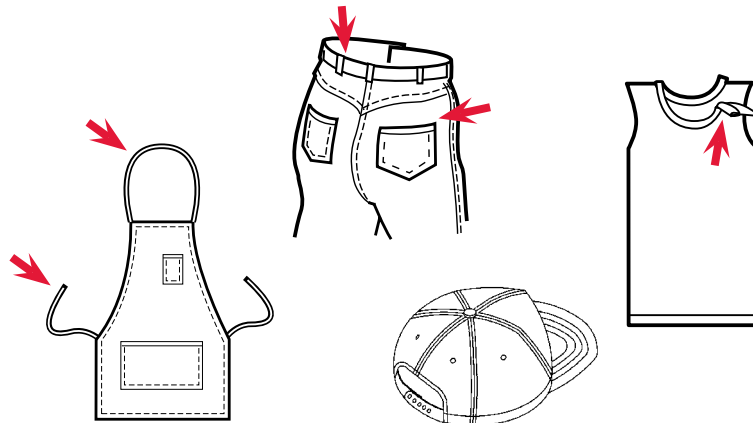

### SPECIFICATIONS

Voltage (v/ph/hz)	220v 1ph
Current (amps)	5
Air pressure (psi)	60
Air consumption (cfm)	4

[www.atlatt.com](http://www.atlatt.com) • [sales@atlatt.com](mailto:sales@atlatt.com)

**PATENTS:** Our equipment may be covered by one or more patents. Please go to the following web page for an up-to-date patent list: [www.atlatt.com/patents.php](http://www.atlatt.com/patents.php)  
© 2018 Atlanta Attachment Co. 17168042718

362 Industrial Park Drive  
Lawrenceville, GA 30046 USA  
+1 (770) 963-7369 • FAX +1 (770) 963-7641



**Atlanta Attachment Company**

The Company that  
**Sudden Service**  
built